

OWNER

WASHINGTON ELEMENTARY SCHOOL DISTRICT
4650 WEST SWEETWATER AVENUE
GLENDALE, ARIZONA 85304
PHONE: (602) 347-4835
FAX: (602) 347-4836
CONTACT: MIKE KRAMER

CIVIL ENGINEER

KIMLEY-HORN & ASSOCIATES
7740 NORTH 16TH STREET, SUITE 300
PHOENIX, ARIZONA 85020
PHONE: (602) 944-5500
FAX: (602) 944-7423
CONTACT: SEAN WOZNY

PREVIOUS CLASSROOM & SITE IMPROVEMENTS - DISTRICT FUNDED 2017 & 2018

- 1 NEW CLASSROOM BUILDING
- 2 NEW PLAYGROUND
- 3 NEW PARENT PICK-UP / DROP OFF
- 4 NEW PARKING AREA

PROPOSED FIRE LANE PROJECT KEY NOTES - ADJACENT WAYS

- 1 CONSTRUCT FIRE LANE AREA WITH MAG CLASS 'A', 8-INCH CONCRETE PAVEMENT WITH 10-INCH TURNDOWNS WITH 6x6 - W1.4XW1.4 OVER 8-INCH PREPARED SUB-GRADE. JOINTING AS PER PLAN & DETAILS. DOWEL CONNECT TO EXISTING CONCRETE ON ALL EXISTING SIDES. SUB-GRADE PREPARATION AS PER MAG SPEC. SECTION 301. CONCRETE PAVEMENT AS PER MAG SPEC. SECTION 324.
- 2 INSTALL CONCRETE CATCH BASIN AS PER MAG STD. DTL. 535, TYPE F WITH FRAME AND COVER.
- 3 INSTALL 12-INCH DIAMETER HDPE STORM DRAIN PIPE, TYP.
- 4 INSTALL 18-INCH DIAMETER HDPE STORM DRAIN PIPE, TYP.
- 5 RELOCATE EXISTING FIRE HYDRANT, TYP.
- 6 EXISTING WATER LINE TO REMAIN, PROTECT IN PLACE.
- 7 INSTALL 120-INCH DIAMETER CMP PIPE WITH ACCESS INLETS.
- 8 INSTALL MAXWELL PLUS, DUAL CHAMBER DRYWELL.
- 9 CONTRACTOR TO SAWCUT REMOVE EXISTING SIDEWALK, AC PAVEMENT AND CONSTRUCT CONCRETE DRIVEWAY AS PER C.O.P. STD DTL. 1255, TYP.
- 10 CONTRACTOR TO REMOVE EXISTING CONCRETE DRIVEWAY AND REPLACE WITH CONCRETE SIDEWALK, 5-INCH THICK, MAG TYPE 'A', 3,500 PSI, TYP.
- 11 REMOVE AND REPLACE CHAIN LINK FENCE, 6FT HT WITH DOUBLE RAILS (BY DISTRICT).
- 12 REMOVE EXISTING GATE, TYP.
- 13 REMOVE CONCRETE SCUPPER PAN.

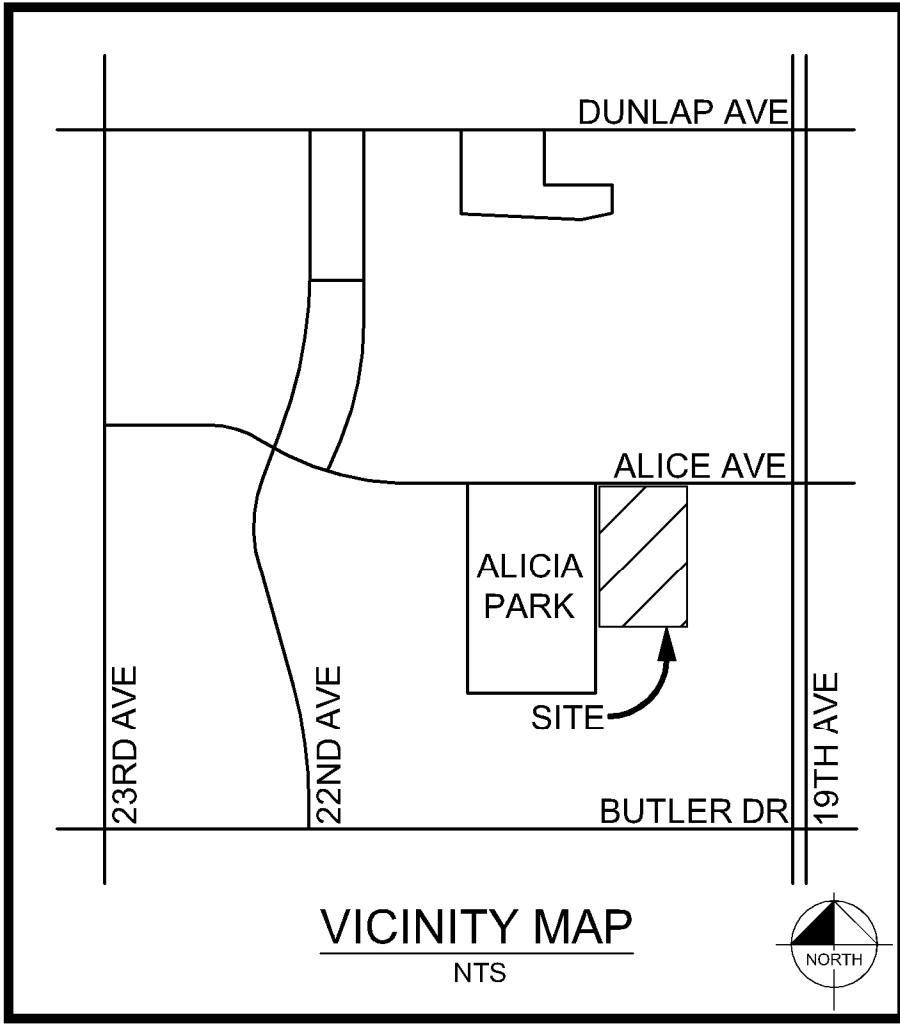

CITY OF PHOENIX ALICIA PARK

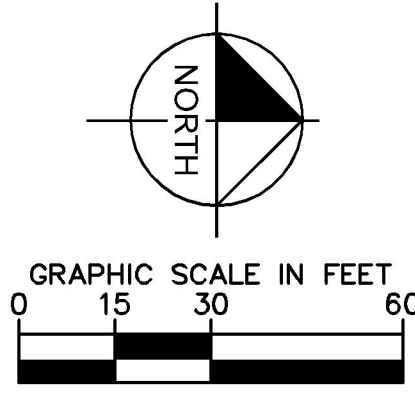

Kimley»Horn

(C) 2018 KIMLEY-HORN AND ASSOCIATES, INC.
7740 North 16th Street, Suite 300
Phoenix, Arizona 85020 (602) 944-5500

SCALE (H): AS SHOWN
SCALE (V): AS SHOWN
DESIGNED BY: SW
DRAWN BY: SW
CHECKED BY: SW
DATE: 04/03/2017

RICHARD E MILLER SCHOOL
SITE PLAN
SITE IMPROVEMENTS
2021 W ALICE AVENUE, PHOENIX, AZ 85021

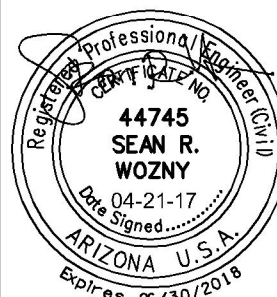

PROJECT NO.
191401003

DRAWING NAME
C1.1

OF

CCPR#: KIVA#: SDEV#: QS: HH: ENV#: 04/03/2017